

## CADEL SMART 60



[Ver más información online](#)

# SMART 60

Wood Insertion Cookers / Free standing wood cookers



www.forjas-salvador.com

Certificate model name : SMART 60



Nominal power	kW	6,5
Reduced power	kW	-
Introduced thermal power (max)	kW	7,7
Nominal water useful power	kW	-
Reduced water useful power	kW	-
Nominal efficiency	%	85,1
Reduced efficiency	%	-
Heating volume (min-max)	m <sup>3</sup>	185
Nominal CO at 13% O <sub>2</sub>	%	0,085
Reduced CO at 13% O <sub>2</sub>	%	-
Emissions CO (13% O <sub>2</sub> ) (min-max)	mg/Nm <sup>3</sup>	1062
Emissions OGC (13% O <sub>2</sub> ) (min-max)	mg/Nm <sup>3</sup>	64
Emissions NOX (13% O <sub>2</sub> ) (min-max)	mg/Nm <sup>3</sup>	90
Dust content at 13% O <sub>2</sub> (min-max)	mg/Nm <sup>3</sup>	21
Boiler capacity (H <sub>2</sub> O)	l	-
Hopper capacity	kg	-
Combustible		Legna
Hourly consumption (min-max)	kg/h	1,8
Autonomy (min-max)	h	-
Ignition electrical absorption (max)	W	-
Operating electrical absorption (max)	W	50
Supply and frequency	V - Hz	230 - 50
Chimney flue depression	Pa	12
Exhaust diameter	mm	140
Combustion air inlet diameter	mm	-
Mass of smoke (min-max)	g/sec	6,3
Exhaust fumes temperature (max)	°C	185
Net weight	kg	123
Gross weight	kg	136
Exhaust fumes	see	A
Hole combustion air inlet	see	B
Ducting outlet	see	-
Ducting capability up to	m	-

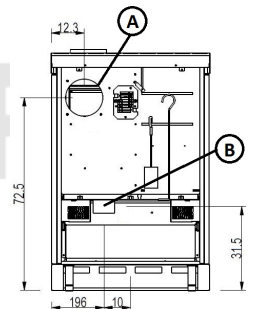
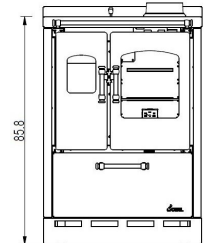
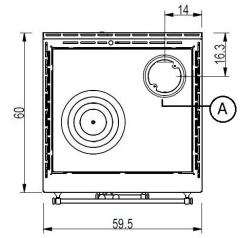

Art. 15A B-VG 2015  
BImSchV 2015  
Regensburg  
München  
Stuttgart  
Aachen



## MATCH

71204010	NEUTRAL STRUCTURE	EAN 8053859014669
6920002	Anthracite steel	EAN 8053859012207
6920003	White steel	EAN 8053859012214
6920004	Red steel	EAN 8053859012221
6921009	Stainless steel	EAN 8053859013884

## OPTIONAL

5020005	Feet	EAN 8053859012597
5020006	Podium inox	EAN 8053859012603
5020008	H4 upstand	EAN 8053859012627
5020009	H6 upstand	EAN 8053859012634
5020014	Top	EAN 8053859012689
5021005	140/150 mm connection	EAN 8053859014256

## PLUS



Cooking



Central Top and back exhaust



Refractory stone inner with 2nd combustion air



OPTIONAL  
Ventilation + light kit



View on the oven



Cast iron door



Built-in



Freestanding

## STOVE PACKING

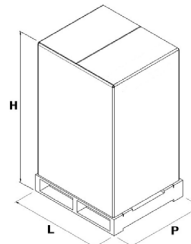

L (cm)	H (cm)	P (cm)
77	100,5	79

VOLUME (m <sup>3</sup> )
0,61

## LINING PACKING

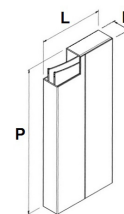

L (cm)	H (cm)	P (cm)	
steel	60	13,5	80

## STOCKING

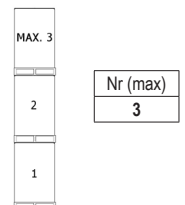

## TRANSPORT

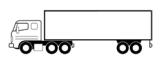

51 pcs